

角接觸球軸承 ANGULAR CONTACT BALL BEARING

高精度 · 高承載 · 長壽命 · 更穩定

HIGH PRECISION · HIGH LOAD · LONG LIFE · MORE STABLE



高精度 HIGH PRECISION

精密加工與嚴格品質控制，確保高精度運行。
Precision machining and strict quality control ensure high precision operation.



高剛性 HIGH RIGIDITY

優化結構設計，提供穩定的支撐與高剛性。
Optimized structural design provides stable support and high rigidity.



高承載 HIGH LOAD CAPACITY

可承受徑向、軸向及純軸向負荷，適用於重負載工況。
Capable of withstanding radial load, axial load, and pure axial load. Suitable for high load conditions.



長壽命 LONG LIFE

優質材料與熱處理工藝，延長軸承使用壽命。
High-quality materials and heat treatment processes extend bearing service life.



低摩擦 · 低噪音 LOW FRICTION · LOW NOISE

精密的性能加工與保持架設計，降低摩擦與噪音。
Precision raceway machining and cage design reduce friction and noise.

角接觸球軸承 ANGULAR CONTACT BALL BEARING

角接觸球軸承可以承受徑向負荷和軸向負荷，也可以承受純軸向負荷，能在較高的轉速下工作。單列角接觸球軸承只能承受一個方向的軸向負荷。在承受徑向負荷時，將引起附加軸向力，並且只能限制軸或外殼在一個方向的軸向位移。若是成對安裝，使一對軸承的外圈相同端面相對，及寬端面對寬端面，窄端面對窄端面，這樣既可避免引起附加軸向力，而且可在兩個方向使軸或外殼限制在軸向游隙內。角接觸球軸承的裝球量比深溝球軸承多，因而負荷容量在球軸承中最大，剛性也強，運轉平穩。可以利用內外圈相互位移調整徑向游隙。

Angular contact ball bearings can withstand radial load, axial load, and pure axial load. It could work under high speed condition. Single row angular contact ball bearings only bear axial load in one direction. If bearing radial load, it will bring a additional axial force, moreover, it only limits shaft or shell axial displacement in one direction. If installed in pairs, wide to wide, narrow to narrow, the bearings can avoid the additional axial force, but also limits the shaft or shell within the axial clearance in two directions. Angular contact ball bearing mounts more rolling balls than deep groove ball bearing, thus, such bearing possesses largest load capacity, strongest rigidity and smoothest operation in the ball bearings. The radial clearance is adjusted by the displacement of the IR and OR.

應用領域 APPLICATIONS



機床主軸

MACHINE TOOL SPINDLES



高精密減速機

HIGH PRECISION REDUCERS



機器人關節

ROBOT JOINTS



航空航天

AEROSPACE



醫療設備

MEDICAL EQUIPMENT



電機設備

ELECTRIC MOTORS

- ✓ 高精度 HIGH PRECISION
- ✓ 高剛性 HIGH RIGIDITY
- ✓ 高承載 HIGH LOAD CAPACITY
- ✓ 低摩擦 · 低噪音 LOW FRICTION · LOW NOISE
- ✓ 長壽命 LONG LIFE



角接觸球軸承 ANGULAR CONTACT BALL BEARING



高精度 · 高承載 · 長壽命 · 更穩定

HIGH PRECISION · HIGH LOAD · LONG LIFE · MORE STABLE



高精度 HIGH PRECISION

精密加工與嚴格品質控制，確保高精度運行。
Precision machining and strict quality control ensure high precision operation.



高剛性 HIGH RIGIDITY

優化結構設計，提供穩定的支撐與高剛性。
Optimized structural design provides stable support and high rigidity.



高承載 HIGH LOAD CAPACITY

可承受徑向、軸向及純軸向負荷，適用於重負載工況。
Capable of withstanding radial, axial and pure axial load. Suitable for high load conditions.



長壽命 LONG LIFE

優質材料與熱處理工藝，延長軸承使用壽命。
High-quality materials and heat treatment processes extend bearing service life.



低摩擦 · 低噪音

精密的滾道加工與保持架設計，降低摩擦與噪音。
Precision raceway machining and cage design reduce friction and noise.

718系列薄壁角接觸球軸承

718 Thin-walled Angular Contact Ball Bearings

高速角接觸球軸承
High speed angular contact ball bearings

718 C 接觸角 Contact angle $\alpha \approx 15^\circ$

718 AC 接觸角 Contact angle $\alpha \approx 25^\circ$

718 B 接觸角 Contact angle $\alpha \approx 40^\circ$

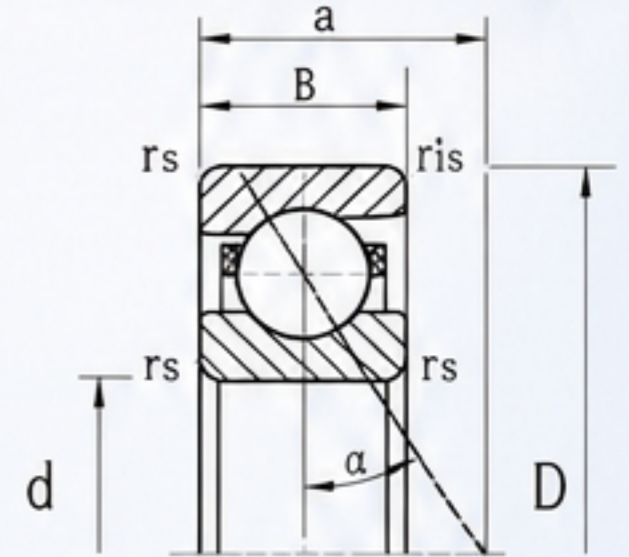

| 軸承型號 Bearing Designations | 外形尺寸 (毫米) Boundary Dimensions (mm) | | | 基本額定負荷 (千牛) Basic Load Rating (kN) | | 極限轉速 (轉/分) Limiting Speed (r/min) | | 重量 (千克) Weight (kg) |
|------------------------------|---------------------------------------|-----|----|---------------------------------------|--------|--------------------------------------|---------|---------------------------|
| | d | D | B | 動態 Cr | 靜態 Cor | 脂潤滑 Grease | 油潤滑 Oil | |
| 71800 | 10 | 19 | 5 | 1.8 | 1.1 | 75000 | 120000 | 0.005 |
| 71801 | 12 | 21 | 5 | 2.0 | 1.4 | 70000 | 110000 | 0.006 |
| 71802 | 15 | 24 | 5 | 2.2 | 1.8 | 60000 | 90000 | 0.007 |
| 71803 | 17 | 26 | 5 | 2.3 | 1.9 | 53000 | 80000 | 0.008 |
| 71804 | 20 | 32 | 7 | 3.9 | 3.4 | 45000 | 67000 | 0.018 |
| 71805 | 25 | 37 | 7 | 4.2 | 4.1 | 38000 | 56000 | 0.022 |
| 71806 | 30 | 42 | 7 | 4.4 | 4.8 | 32000 | 48000 | 0.025 |
| 71807 | 35 | 47 | 7 | 4.6 | 5.5 | 26000 | 40000 | 0.029 |
| 71808 | 40 | 52 | 7 | 4.8 | 6.2 | 24000 | 38000 | 0.032 |
| 71809 | 45 | 58 | 7 | 4.9 | 6.7 | 20000 | 34000 | 0.040 |
| 71810 | 50 | 65 | 7 | 7.4 | 10.0 | 18000 | 30000 | 0.052 |
| 71811 | 55 | 72 | 9 | 10.2 | 13.8 | 16000 | 26000 | 0.081 |
| 71812 | 60 | 78 | 10 | 13.4 | 18.0 | 15000 | 24000 | 0.100 |
| 71813 | 65 | 85 | 10 | 13.4 | 18.8 | 14000 | 22000 | 0.125 |
| 71814 | 70 | 90 | 10 | 13.8 | 20.3 | 13000 | 20000 | 0.133 |
| 71815 | 75 | 95 | 10 | 14.2 | 21.7 | 12000 | 19000 | 0.142 |
| 71816 | 80 | 100 | 10 | 14.5 | 23.1 | 10000 | 18000 | 0.150 |
| 71817 | 85 | 110 | 13 | 21.5 | 32.2 | 10000 | 17000 | 0.262 |
| 71818 | 90 | 115 | 13 | 21.7 | 33.5 | 9500 | 16000 | 0.274 |
| 71819 | 95 | 120 | 13 | 21.9 | 34.7 | 9000 | 15000 | 0.287 |
| 71820 | 100 | 125 | 13 | 22.5 | 37.0 | 8500 | 14000 | 0.301 |
| 71821 | 105 | 130 | 13 | 22.7 | 38.3 | 8500 | 14000 | 0.314 |
| 71822 | 110 | 140 | 16 | 31.8 | 51.6 | 8000 | 13000 | 0.496 |

應用領域 APPLICATIONS



機床主軸

MACHINE TOOL SPINDLES



高精密減速機

HIGH PRECISION REDUCERS



機器人關節

ROBOT JOINTS



航空航天

AEROSPACE



醫療設備

MEDICAL EQUIPMENT



電機設備

ELECTRIC MOTORS



角接觸球軸承 ANGULAR CONTACT BALL BEARING

高精度 · 高承載 · 長壽命 · 更穩定

HIGH PRECISION · HIGH LOAD · LONG LIFE · MORE STABLE



高精度 HIGH PRECISION

精密加工與嚴格品質控制，確保高精度運行。

Precision machining and strict quality control ensure high precision operation.



高剛性 HIGH RIGIDITY

優化結構設計，提供穩定的支撐與高剛性。

Optimized structural design provides stable support and high rigidity.



高承載 HIGH LOAD CAPACITY

可承受徑向、軸向及純軸向負荷，適用於重負載工況。

Capable of withstanding radial, axial and pure axial load. Suitable for high load conditions.



長壽命 LONG LIFE

優質材料與熱處理工藝，延長軸承使用壽命。

High-quality materials and heat treatment processes extend bearing service life.



低摩擦 · 低噪音

精密的滾道加工與保持架設計，降低摩擦與噪音。

Precision raceway machining and cage design reduce friction and noise.

| 軸承型號 Bearing Designations | 外形尺寸 (毫米) Boundary Dimensions (mm) | | | 基本額定負荷 (千牛) Basic Load Rating (kN) | | 極限轉速 (轉/分) Limiting Speed (r/min) | | 重量 (千克) Weight (kg) |
|------------------------------|---------------------------------------|------|-----|---------------------------------------|-------|--------------------------------------|--------|---------------------------|
| | d | D | B | 動態Cr | 靜態Cor | 脂潤滑Grease | 油潤滑Oil | |
| 71824 | 120 | 150 | 16 | 33.1 | 56.9 | 7000 | 11000 | 0.537 |
| 71826 | 130 | 165 | 18 | 38.7 | 67.6 | 6700 | 10000 | 0.782 |
| 71828 | 140 | 175 | 18 | 44.8 | 79.2 | 6000 | 9000 | 0.813 |
| 71830 | 150 | 190 | 20 | 51.2 | 92.0 | 5600 | 8500 | 1.14 |
| 71832 | 160 | 200 | 20 | 52.4 | 97.7 | 5000 | 7500 | 1.21 |
| 71834 | 170 | 215 | 22 | 66.5 | 123.4 | 4800 | 7000 | 1.61 |
| 71836 | 180 | 225 | 22 | 62.3 | 75.9 | 2000 | 2800 | 2 |
| 71838 | 190 | 240 | 24 | 75.1 | 91.6 | 1900 | 2600 | 2.1 |
| 71840 | 200 | 250 | 24 | 74.2 | 91.2 | 1800 | 2400 | 2.38 |
| 71844 | 220 | 270 | 24 | 76.4 | 97.8 | 1700 | 2200 | 2.8 |
| 71848 | 240 | 300 | 28 | 83.5 | 108 | 1500 | 1900 | 4.5 |
| 71852 | 260 | 320 | 28 | 95 | 128 | 1300 | 1700 | 4.85 |
| 71856 | 280 | 350 | 38 | 135 | 178 | 1200 | 1400 | 7.6 |
| 71860 | 300 | 380 | 38 | 162 | 222 | 1100 | 1400 | 11 |
| 71864 | 320 | 400 | 38 | 168 | 235 | 1100 | 1400 | 11.8 |
| 71868 | 340 | 420 | 38 | 174 | 260 | 1000 | 1300 | 12 |
| 71872 | 360 | 440 | 38 | 182 | 285 | 1000 | 1300 | 12.2 |
| 71876 | 380 | 480 | 46 | 235 | 348 | 950 | 1200 | 20.5 |
| 71880 | 400 | 500 | 46 | 247 | 405 | 950 | 1200 | 21.7 |
| 71884 | 420 | 520 | 46 | 251 | 425 | 950 | 1180 | 22 |
| 71888 | 440 | 540 | 46 | 255 | 420 | 860 | 1100 | 24 |
| 71892 | 460 | 580 | 56 | 322 | 538 | 860 | 1000 | 33.5 |
| 71896 | 480 | 600 | 56 | 315 | 610 | 870 | 1100 | 36 |
| 718/500 | 500 | 620 | 56 | 315 | 465 | 800 | 950 | 37.3 |
| 718/530 | 530 | 650 | 56 | 315 | 480 | 750 | 900 | 41.1 |
| 718/560 | 560 | 680 | 56 | 328 | 525 | 700 | 850 | 42.7 |
| 718/600 | 600 | 730 | 60 | 345 | 710 | 670 | 800 | 52.7 |
| 718/630 | 630 | 780 | 69 | 420 | 760 | 630 | 750 | 65.7 |
| 718/670 | 670 | 820 | 69 | 420 | 780 | 560 | 670 | 82.8 |
| 718/710 | 710 | 870 | 74 | 451 | 905 | 530 | 630 | 96.1 |
| 718/750 | 750 | 920 | 78 | 515 | 1240 | 480 | 610 | 110 |
| 718/800 | 800 | 980 | 82 | 545 | 1360 | 430 | 510 | 132 |
| 718/900 | 950 | 1030 | 85 | 600 | 1430 | 360 | 530 | 155 |
| 718/950 | 950 | 1150 | 90 | 663 | 1620 | 360 | 430 | 188 |
| 718/1000 | 1000 | 1220 | 100 | 635 | 1720 | 340 | 400 | 230 |

應用領域 APPLICATIONS



機床主軸

MACHINE TOOL SPINDLES



高精密減速機

HIGH PRECISION REDUCERS



機器人關節

ROBOT JOINTS



航空航天

AEROSPACE



醫療設備

MEDICAL EQUIPMENT



電機設備

ELECTRIC MOTORS

