

UCFL 200 type
Normal Duty
Set-screw Locking

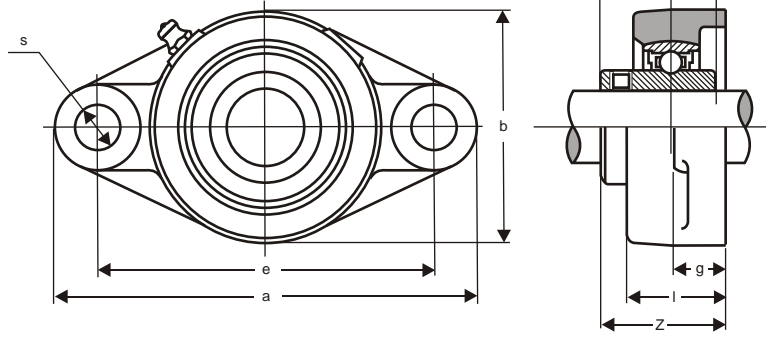

Unit No.	Shaft Diam. mm	Dimensions mm										Bolt Size mm	Bearing No.	Housing No.	Weight Kg.
		a	e	i	g	l	s	b	Z	Bi	n				
UCFL 201	12	113	90	15	12	25.5	12	60	33.3	31	12.7	M 10	UC 201	FL 204	0.5
UCFL 202	15	113	90	15	12	25.5	12	60	33.3	31	12.7	M 10	UC 202	FL 204	0.5
UCFL 203	17	113	90	15	12	25.5	12	60	33.3	31	12.7	M 10	UC 203	FL 204	0.5
UCFL 204	20	113	90	15	12	25.5	12	60	33.3	31	12.7	M 10	UC 204	FL 204	0.5
UCFL 205	25	130	99	16	14	27	16	68	35.7	34.1	14.3	M 14	UC 205	FL 205	0.6
UCFL 206	30	148	117	18	14	31	16	80	40.2	38.1	15.9	M 14	UC 206	FL 206	1.0
UCFL 207	35	161	130	19	16	34	16	90	44.4	42.9	17.5	M 14	UC 207	FL 207	1.2
UCFL 208	40	175	144	21	16	36	16	100	51.2	49.2	19	M 14	UC 208	FL 208	1.6
UCFL 209	45	188	148	22	18	38	19	108	52.2	49.2	19	M 16	UC 209	FL 209	1.9
UCFL 210	50	197	157	22	18	40	19	115	54.6	51.6	19	M 16	UC 210	FL 210	2.2
UCFL 211	55	224	184	25	20	43	19	130	58.4	55.6	22.2	M 16	UC 211	FL 211	3.2
UCFL 212	60	250	202	29	20	48	23	140	68.7	65.1	25.4	M 20	UC 212	FL 212	4.1
UCFL 213	65	258	210	30	24	50	23	155	69.7	65.1	25.4	M 20	UC 213	FL 213	5.1
UCFL 214	70	265	216	31	24	54	23	160	75.4	74.6	30.2	M 20	UC 214	FL 214	6.0
UCFL 215	75	275	225	34	24	56	23	165	78.5	77.8	33.3	M 20	UC 215	FL 215	6.5
UCFL 216	80	290	233	34	24	58	25	180	83.3	82.6	33.3	M 22	UC 216	FL 216	8.0
UCFL 217	85	305	248	36	26	63	25	190	87.6	85.7	34.1	M 22	UC 217	FL 217	9.5
UCFL 218	90	320	265	40	26	68	25	205	96.3	96	39.7	M 22	UC 218	FL 218	11.9

UCFL X00 type
Medium Duty
Set-screw Locking

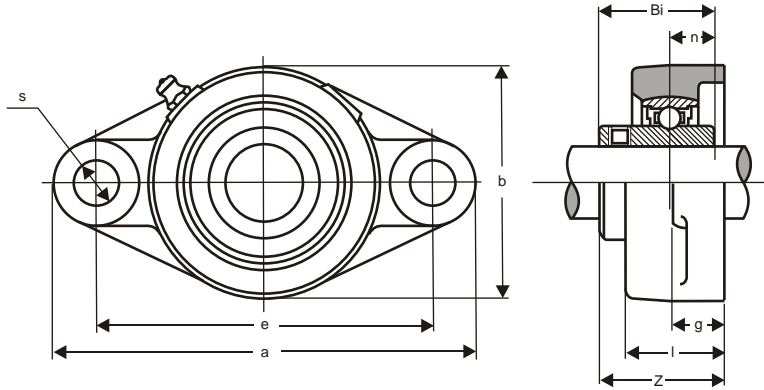

Unit No.	Shaft Diam. mm	Dimensions mm										Bolt Size mm	Bearing No.	Housing No.	Weight Kg.
		a	e	i	g	l	s	b	Z	Bi	n				
UCFL X05	25	141	117	19	13	30	12	83	40.2	38.1	15.9	M 10	UC X05	FL X05	1.0
UCFL X06	30	156	130	19	14	34	16	95	44.4	42.9	17.5	M 14	UC X06	FL X06	1.4
UCFL X07	35	171	144	21	14	38	16	105	51.2	49.2	19	M 14	UC X07	FL X07	1.9
UCFL X08	40	179	148	22	14	40	16	111	52.2	49.2	19	M 14	UC X08	FL X08	2.0
UCFL X09	45	189	157	23	14	40	16	116	55.6	51.6	19	M 14	UC X09	FL X09	2.4
UCFL X10	50	216	184	26	20	44	19	133	59.4	55.6	22.2	M 16	UC X10	FL X10	3.6

UCFL 300 type
Heavy Duty
Set-screw Locking

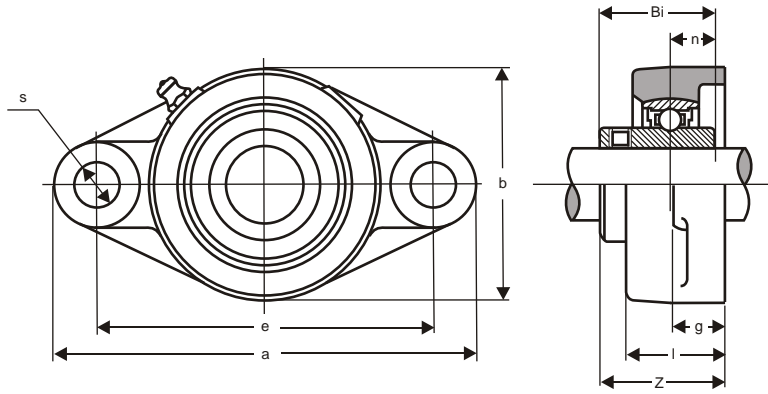

Unit No.	Shaft Diam. mm	Dimensions mm										Bolt Size mm	Bearing No.	Housing No.	Weight Kg.
		a	e	i	g	l	s	b	Z	Bi	n				
UCFL 305	25	150	113	16	13	29	19	80	39	38	15	M 16	UC 305	FL 305	1.1
UCFL 306	30	180	134	18	15	32	23	90	44	43	17	M 20	UC 306	FL 306	1.5
UCFL 307	35	185	141	20	16	36	23	100	49	48	19	M 20	UC 307	FL 307	1.8
UCFL 308	40	200	158	23	17	40	23	112	56	52	19	M 20	UC 308	FL 308	2.4
UCFL 309	45	230	177	25	18	44	25	125	60	57	22	M 22	UC 309	FL 309	3.4
UCFL 310	50	240	187	28	19	48	25	140	67	61	22	M 22	UC 310	FL 310	4.3
UCFL 311	55	250	198	30	20	52	25	150	71	66	25	M 22	UC 311	FL 311	5.1
UCFL 312	60	270	212	33	22	56	31	160	78	71	26	M 27	UC 312	FL 312	6.2
UCFL 313	65	295	240	33	25	58	31	175	78	75	30	M 27	UC 313	FL 313	7.4
UCFL 314	70	315	250	36	28	61	35	185	81	78	33	M 30	UC 314	FL 314	9.0
UCFL 315	75	320	260	39	30	66	35	195	89	82	32	M 30	UC 315	FL 315	10.0
UCFL 316	80	355	285	38	32	68	38	210	90	86	34	M 33	UC 316	FL 316	12.6
UCFL 317	85	370	300	44	32	74	38	220	100	96	40	M 33	UC 317	FL 317	14.5
UCFL 318	90	385	315	44	36	76	38	235	100	96	40	M 33	UC 318	FL 318	17.1
UCFL 319	95	405	330	59	40	94	41	250	121	103	41	M 36	UC 319	FL 319	21.8
UCFL 320	100	440	360	59	40	94	44	270	125	108	42	M 39	UC 320	FL 320	26.5
UCFL 321	105	440	360	59	40	94	44	270	127	112	44	M 39	UC 321	FL 321	28.2
UCFL 322	110	470	390	60	42	96	44	300	131	117	46	M 39	UC 322	FL 322	33.1
UCFL 324	120	520	430	65	48	110	47	330	140	126	51	M 42	UC 324	FL 324	45.7
UCFL 326	130	550	460	65	50	115	47	360	146	135	54	M 42	UC 326	FL 326	57.5
UCFL 328	140	600	500	75	60	125	51	400	161	145	59	M 45	UC 328	FL 328	79.7

BLFL type
Light Duty
Set-screw Locking

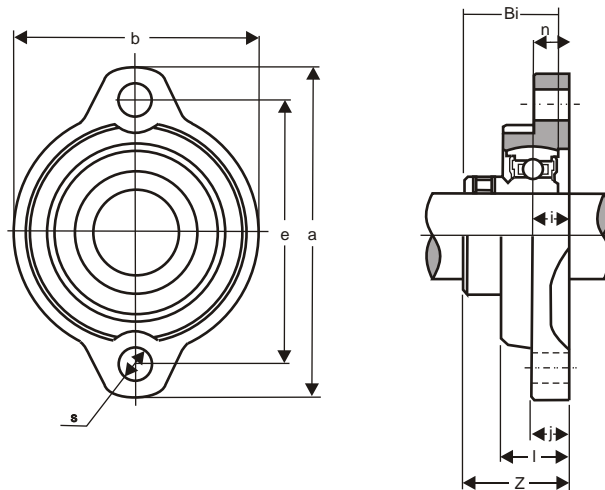

Unit No.	Shaft Diam. mm	Dimensions mm										Bolt Size mm	Bearing No.	Housing No.	Weight Kg.
		a	e	i	g	l	s	b	Z	Bi	n				
BLFL 1J	12	81	63.5	9.5	9.5	18	7	56	25.5	22	6	M 6	B 1	LFL 3J	0.3
BLFL 2J	15	81	63.5	9.5	9.5	18	7	56	25.5	22	6	M 6	B 2	LFL 3J	0.3
BLFL 3J	17	81	63.5	9.5	9.5	18	7	56	25.5	22	6	M 6	B 3	LFL 3J	0.3
BLFL 4J	20	90	71.5	11	11	20	10	63	28.7	24.7	7	M 8	B 4	LFL 4J	0.3
BLFL 5J	25	95	76	11	11	20	10	69	30.5	27	7.5	M 8	B 5	LFL 5J	0.4
BLFL 6J	30	113	90.5	12	12	22.5	12	79	34.3	30.3	8	M 10	B 6	LFL 6J	0.6
BLFL 7J	35	122	100	13	13	24	12	89	37.4	32.9	8.5	M 10	B 7	LFL 7J	0.8

BPFL type
Light Duty
Set-screw Locking

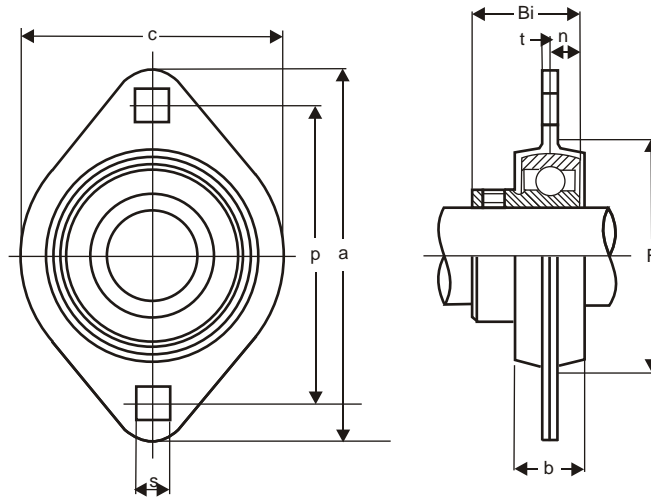

Unit No.	Shaft Diam. mm	Dimensions mm									Bolt Size mm	Bearing No.	Housing No.	Weight kg
		a	e	t	b	s	c	F(Min.)	Bi	n				
BPFL 1	12	81	63.5	2	14	7	59	49	22	6	M 6	B 1	PFL 3	0.3
BPFL 2	15	81	63.5	2	14	7	59	49	22	6	M 6	B 2	PFL 3	0.2
BPFL 3	17	81	63.5	2	14	7	59	49	22	6	M 6	B 3	PFL 3	0.2
BPFL 4	20	90	71.5	2	16	9	67	56	24.7	7	M 8	B 4	PFL 4	0.3
BPFL 5	25	95	76	2	18	9	71	60	27	7.5	M 8	B 5	PFL 5	0.4
BPFL 6	30	113	90.5	2.6	18	11	84	71	30.3	8	M 10	B 6	PFL 6	0.6
BPFL 7	35	125	100	2.6	20	11	94	81	32.9	8.5	M 10	B 7	PFL 7	0.7