

BEARING UNITS

TAKE-UP UNITS

UCT 200 type

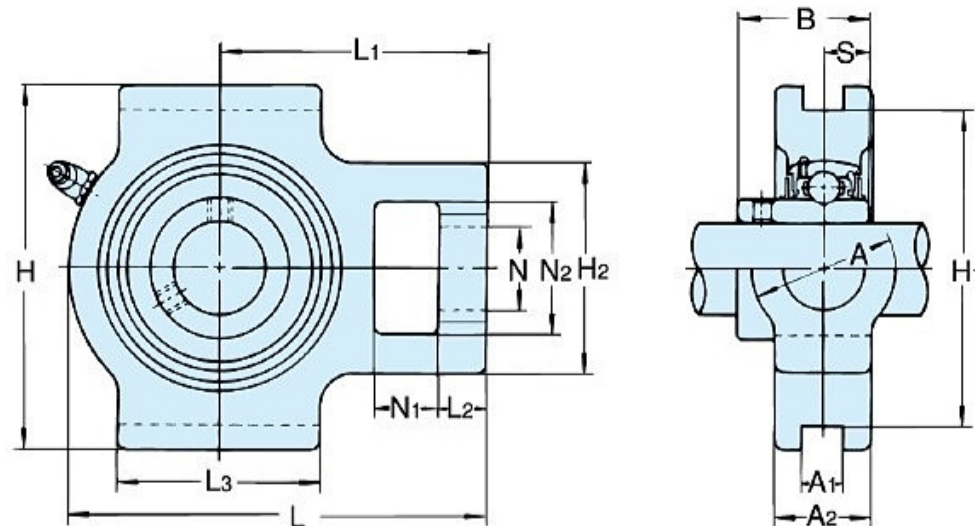

Shaft Diam. mm	Unit No.	Dimensions mm															Bearing		Housing No.	Weight kg	
		N ₁	L ₂	H ₂	N ₂	N	L ₃	A ₁	H ₁	H	L	A	A ₂	L ₁	B	S	No.	Basic Load Rating kN Cr Cor			
12	UCT 201	16	10	51	32	19	51	12	76	89	94	32	21	61	31	12.7	UC 201	12.8	6.6	T 204	0.79
15	UCT 202	16	10	51	32	19	51	12	76	89	94	32	21	61	31	12.7	UC 202	12.8	6.6	T 204	0.77
17	UCT 203	16	10	51	32	19	51	12	76	89	94	32	21	61	31	12.7	UC 203	12.8	6.6	T 204	0.76
20	UCT 204	16	10	51	32	19	51	12	76	89	94	32	21	61	31	12.7	UC 204	12.8	6.6	T 204	0.74
25	UCT 205	16	10	51	32	19	51	12	76	89	97	32	24	62	34.1	14.3	UC 205	14	7.9	T 205	0.82
30	UCT 206	16	10	56	37	22	57	12	89	102	113	37	28	70	38.1	15.9	UC 206	19.6	11.3	T 206	1.3
35	UCT 207	16	13	64	37	22	64	12	89	102	129	37	30	78	42.9	17.5	UC 207	25.9	15.4	T 207	1.6
40	UCT 208	19	16	83	49	29	83	16	102	114	144	49	33	88	49.2	19	UC 208	29.3	17.9	T 208	2.4
45	UCT 209	19	16	83	49	29	83	16	102	117	144	49	35	87	49.2	19	UC 209	33	20.5	T 209	2.4
50	UCT 210	19	16	83	49	29	86	16	102	117	149	49	37	90	51.6	19	UC 210	35.5	23.2	T 210	2.5
55	UCT 211	25	19	102	64	35	95	22	130	146	171	64	38	106	55.6	22.2	UC 211	43	29.4	T 211	4
60	UCT 212	32	19	102	64	35	102	22	130	146	194	64	42	119	65.1	25.4	UC 212	52.5	36.1	T 212	5.1
65	UCT 213	32	21	111	70	41	121	26	151	167	224	70	44	137	65.1	25.4	UC 213	57.5	40	T 213	7
70	UCT 214	32	21	111	70	41	121	26	151	167	224	70	46	137	74.6	30.2	UC 214	62	44	T 214	7.1
75	UCT 215	32	21	111	70	41	121	26	151	167	232	70	48	140	77.8	33.3	UC 215	66	48.2	T 215	7.5
80	UCT 216	32	21	111	70	41	121	26	165	184	235	70	51	140	82.6	33.3	UC 216	72.5	53	T 216	8.5
85	UCT 217	38	29	124	73	48	157	30	173	198	260	73	54	162	85.7	34.1	UC 217	83.5	61.8	T 217	11.2